

# BeautiCem SA

Self-Adhesive Resin Cement



 **PRG**  
Technology



# BeutiCem SA

is a self-etch, self-adhesive, dual-cure resin cement which easily, quickly and reliably adheres to enamel and dentine, metals, ceramics and indirect resins, without the need for separate bonding or phosphoric acid etching.

BeutiCem SA greatly simplifies cementation by eliminating these technique-sensitive steps and providing an easy delivery system. The product comes in a double syringe cartridge with auto-mixing tips, consistently mixing the cement in the correct ratio and without any air inclusions.

Moreover, this cement releases and recharges fluoride, thanks to SHOFU's proprietary S-PRG filler particles.



## Remarkable strength and durability

The two dual-adhesive monomers of BeutiCem SA guarantee strong adhesion to natural tooth structure and all indirect restorative materials or types of restorations to be cemented.

The catalyst optimises the polymerisation processes taking place in the resin in both chemical and dual cure modes. This leads to superior mechanical properties, ensuring high resistance to occlusal stress and long-lasting restorations.

The excellent radiopacity facilitates diagnoses in future examinations.

### Flexural strength

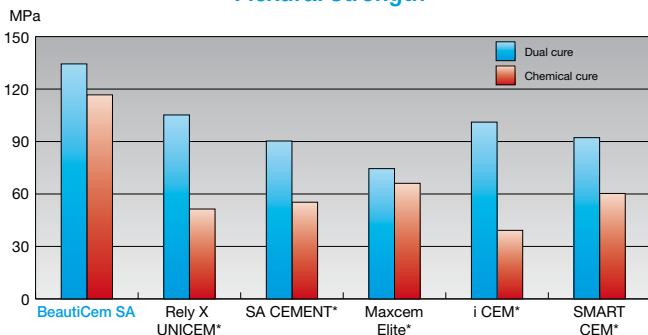

### Bonding strength of zirconia to dentine

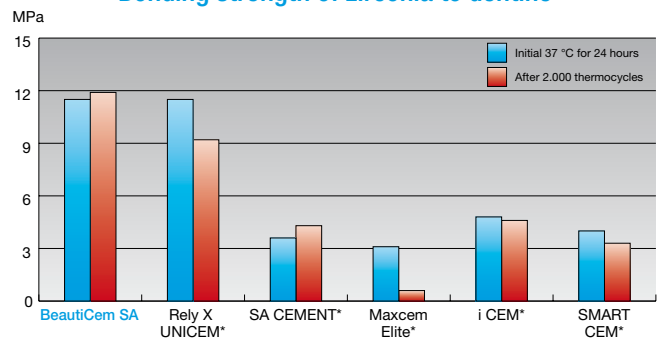

### Bonding strength of stainless steel to NP alloys

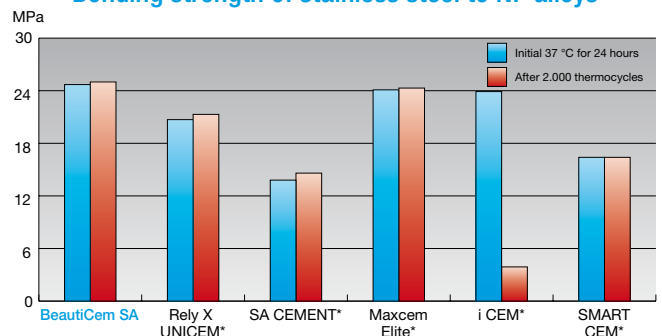

### Bonding strength of stainless steel to zirconia

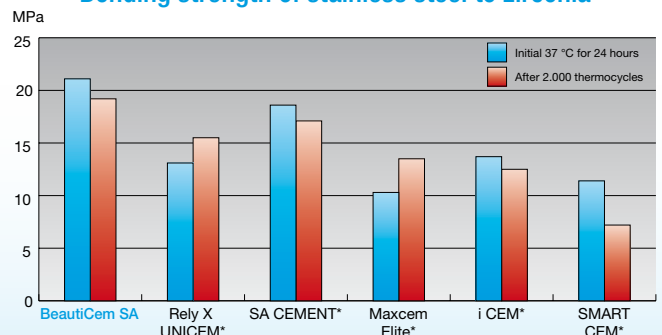

## Virtually invisible margins

BeutiCem SA is a resin cement with ideal viscosity, i.e. it is not too thin, enabling controlled delivery and accurate restoration placement.

Thanks to its thixotropic flow behaviour, it spreads to an even, bubble-free layer that is just 11.8 µm thick, making restoration margins virtually undetectable.

Excess material is easily removed "in one piece" in a rubber-like consistency after very brief light curing or about 3-4 minutes of chemical curing.

Film thickness

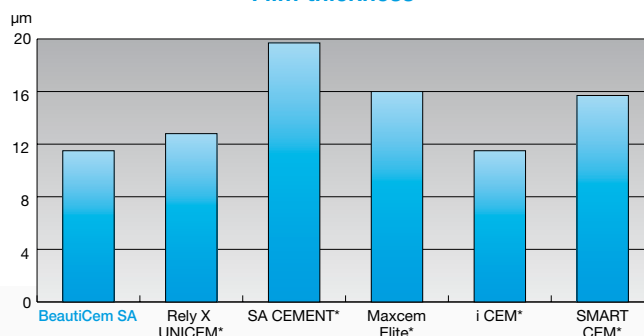

## Easy cementation in a few simple steps

The addition of phosphonic acid monomer and carboxylic acid monomer eliminates the need to separately condition the tooth structure with concentrated phosphoric acid.

Separate conditioning of the restoration surfaces to be cemented is also unnecessary. Only restorations made of silicate ceramics should be silanised, e.g. with Porcelain Primer.

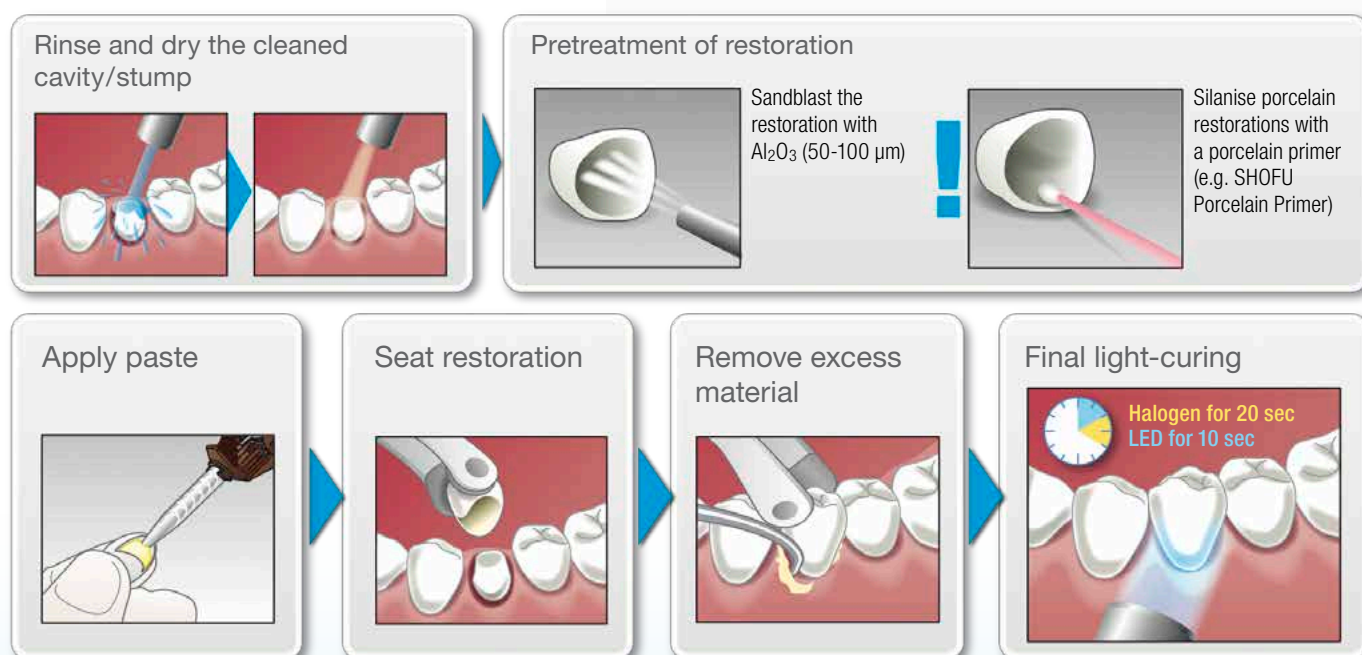

A carefully controlled matrix-filler ratio optimises the refractive index to achieve the highest possible translucency for aesthetically challenging cases. The specially formulated catalyst of BeautiCem SA ensures excellent colour stability and maximum resistance to discolouration.

## Advantages at a Glance

- Durable bond to a wide range of materials
- No need for separate phosphoric acid etching, priming or bonding of enamel and dentine
- Outstanding physical properties
- High translucency for aesthetically challenging cases
- Low layer thickness (11.8 µm)
- Effective fluoride release for sustained anticariogenic and antibacterial properties

## Indications

For cementation of

1. all-ceramic inlays, onlays, crowns and bridges (e.g. Vintage ZR)
2. dentures made with precious, semiprecious and nonprecious alloys, including titanium
3. PFM crowns and bridges (e.g. Vintage PRO, Vintage MP and Vintage Halo)
4. CAD/CAM restorations
5. indirect composite inlays, onlays, crowns and bridges (e.g. Ceramage and Ceramage UP)
6. all-ceramic, composite and metal restorations on implant abutments
7. various kinds of metal and composite post and crowns

## Order Information



### BeautiCem SA

Auto-mixing syringe, 5 ml,  
with 10 mixing tips

Available shades:

Clear – PN 3213

Ivory – PN 3214



**SHOFU INC.** 11 Kamitakamatsu-cho, Fukuine, Higashiyama-ku, Kyoto 605-0983, Japan  
**SHOFU DENTAL GmbH** An der Pönt 70, 40885 Ratingen, Germany, [www.shofu.de](http://www.shofu.de)

SHOFU is a registered trademark of SHOFU INC. All other trademarks and registered trademarks are the property of their respective holders. SHOFU INC. reserves the right to change specifications without notice.

Official Partner  
  
Minimally Invasive  
Cosmetic Dentistry

440202 - 10/2020