

# GC Fuji IX GP™ EXTRA

## TECHNIQUE GUIDE



1  
Recommended: Apply  
CAVITY CONDITIONER  
(GC) for **10 sec.**



2  
Rinse and gently dry, do  
not desiccate.

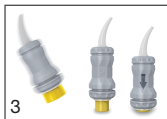

3  
Shake or tap. Depress  
plunger.



4  
Mix for **10 sec.** Working  
time is **1 min. 15 sec.**  
from start of mix.



5  
Insert into Capsule Applicator.  
Click twice to prime  
capsule.



6  
Dispense within  
**10 sec.**



7  
Pack and contour.  
Avoid moisture  
contamination and  
desiccation.



8  
Final finishing after  
**2 min. 30 sec.**  
from start of mix.



9  
Apply G-COAT PLUS™.  
**DO NOT AIR BLOW.\***  
\*Alternatively, apply GC Fuji  
VARNISH™ (blow dry) or  
GC Fuji COAT™ LC (light cure).

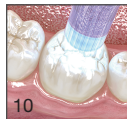

10  
Light cure for **20 sec.**

