

2015

Flight Dental Systems



**A Division of HR Dental Products
Inc.**



[A6-E PATIENT CHAIR USER MANUAL]

Copyright © 2015. HR Dental Products Inc. A-Series Operatories.

Certificate of Warranty

Flight Dental Systems warrants all Flight operatory products sold and installed by authorized Flight dealers, to the original owner-operator to be free of defects in materials and workmanship for a period of Five (5) years from the date of installation in original owner-operator's premises. To activate this warranty, the owner-operator must fill out and return a product registration and warranty activation card to Flight Dental Systems within 30 days of installation of the equipment.

Authorized Dealer: _____

Installed by: _____

Product Serial
Number: _____

Product
Description: _____

Product Model: _____

Purchased Date: _____ Invoice Number: _____

End User Name: _____

Telephone: _____ Fax: _____

Email: _____

Address: _____

City: _____ State/Province: _____

Zip code: _____ Country: _____

WARRANTY START ON: _____

WARRANTY ENDS ON: _____

WARRANTY

If within the warranty time limits described below a product or any of its components fail, the original user-owner must contact an authorized

Flight Dental Systems dealer with the product sale and service records. Should the dealer not be able to complete the repair, the dealer may contact Flight Dental Systems for disposition. The product's model and serial number, the original Flight Dental Systems invoice number must be furnished. Transportation charges to and from Flight Dental Systems, if necessary, must be paid by the dealer. If upon receipt at the factory, an examination reveals faulty or defective original parts, materials, or workmanship, Flight Dental Systems will, at its sole discretion issue a credit.

This warranty does not cover damages caused by misuse, accident, neglect or damage caused by the use of replacement parts which were not manufactured or distributed by Flight Dental Systems. Usage of replacement parts not manufactured or distributed by Flight Dental Systems may nullify this warranty.

CHAIRS, DELIVERY SYSTEMS AND LIGHTS

All chairs sold and installed by authorized Flight Dental Systems dealers are warranted to be free from defects in parts, workmanship and materials for five (5) years, unless otherwise stated, from date of purchase.

The Linak motors are warranted for three (3) years.

Hydraulic pumps, manifolds and cylinders are warranted for two (2) years. Base, unit covers, foot control, circuit board, limit switches and prepositioning switches are warranted for one (1) year.

All delivery systems sold and installed by authorized Flight Dental Systems dealers are warranted for five (5) years from defects in parts, workmanship and materials, unless otherwise stated, from date of purchase. Wear and tear items are not included in the warranty such as gaskets, tubing and filters.

All lights sold by Flight Dental Systems are warranted for (1) one year to be free from defects in parts, workmanship and materials, unless otherwise stated, from date of purchase.

All stools sold by Flight are warranted for five (5) years from manufacture defect and workmanship. Stool ring, stool seat and stool casters are warranted for one (1) year.

Upholstery, or surface discoloration or abrasion from cleaners and disinfectants are not considered a manufacturer's defect and will not be covered by this warranty.

The warranty excludes all normal expected service items such as but not limited to: light bulbs, filters, o-rings, hoses, HVE valves, SE valves and 3-way syringes.

The warranty excludes add-ons such as scalers intraoral handpiece illumination systems and custom upholstery materials. Warranty is limited to repair or replacement as determined by Flight Dental Systems and does not include any shipping or dealer labor charges. Products returned to the factory and determined to be defective will be repaired or replaced free of charge. If a product is installed by anyone other than an authorized Flight Dental Systems dealer, or their representative, all warranties will be void. No claim for labor or consequential damages will be allowed.

ADD-ON ACCESSORIES

All intraoral handpiece illumination systems and accessories are warranted to be free from defects in parts, workmanship and materials for one (1) year from date of purchase unless otherwise noted. Lamps are warranted to be free from manufacturing defects in material and workmanship at the time of installation in an electrical circuit having the correct characteristics. The useful life of lamps is not covered under warranty. Scalers and accessories featured in this catalog carry a manufacturer's warranty and are not covered by the Flight Dental Systems warranty. Please contact the manufacturer directly for all warranty and/or service issues or questions.

REPLACEMENT PARTS

Replacement parts and accessories are warranted for a period of one (1) year from date of purchase from Flight Dental Systems. Replacement parts shall not interrupt or prolong the term of the original warranty.

GENERAL

Flight Dental Systems will not be responsible for dealer or service company labor charges, or shipping costs. Claims for shipping damage must be filed with the carrier.

RETURN POLICY

No goods shall be returned without prior permission by Flight Dental Systems. If permission is granted for the return of the goods, the amount of credit issued, if any, will be at the sole discretion of the Flight Dental Systems home office in accordance with established policies. If a return for non-warranted credit is authorized, a 20% restocking fee will be charged on all catalogued items.

No returns on replacement parts after 180 days from date of purchase from Flight Dental Systems. The customer is responsible for any freight costs. Call Customer Service to obtain a Return Authorization Number (RMA) before returning any item for credit consideration.

Product information and photography included in this catalog were as accurate as possible at the time of publication. Subsequent refinements may be evident in the actual product. Prices and specifications are subject to change without notice.

Contents

Welcome	6
Overview	7
Overview of the Features	8
General Information.....	9
Minimum Requirements	9
Ideal Working Conditions.....	9
Transport and Storage Conditions	9
Specifications and Conformance to Standards:	9
Statement of Intended Use:	9
Compatible Accessories.....	10
Warning.....	10
Installation.....	10
Tools Required for Installation	10
Basic Installation.....	10
Positioning of Chair in Operating Room	11
Provision of Utilities to the Dental Unit	11
Junction Box Utility Connections Specifications	11
ELECTRICAL:	11
Securing Chair Base.....	12
Operation of the Dental Chair.....	12
Power On/Off Button.....	12
Control Panels for Movement of the Flight Unit.....	13
Movement of chair	15
Manual Mode	15
Automatic Mode	15
Programming the Chair.....	16
Setting the Chair Soft Limits	16
The Headrest	17
Wheelchair Patients	17
Patient Chair Up/Down Speed Adjustment	17
Cleaning and Upholstery Care	18

Chair Structure Specifications (mm-inch) 21

Electrical/Hydraulic Diagram 23

Welcome

Welcome to the Flight Dental Unit Owner's Guide. This guide is a source of technical information for installation, operation and maintenance of the Flight Dental Systems A6-E Patient Chair.

The Flight Dental Systems A6-E Patient Chair is intended to supply power and serve as a base for dental devices and accessories. The intended use is in the treatment of dental patients in the dental clinic/office environment. The units are to be used by trained dentists, dental hygienists, dental technicians and dental assistants.

This document is intended for use by technicians and for practitioners and staff during installation, operation and maintenance of the Flight dental unit. This guide provides descriptions and operation instructions for the use of the Flight Dental unit. It contains protocols for programming chair functions, chair operations, adjustments, and maintenance and upholstery removal.

Only factory trained technicians should attempt to install or service this equipment. Technicians should refer to this manual prior to commencing installation of any Flight Dental Systems operatory equipment. Failure to follow the directions may result in damage to the equipment and/or injury to the installer, user, or patients.

Operators should refer to this manual prior to first using their new equipment in order to obtain optimal use of all of the features and benefits provided by this advanced dental system. Operators should also read this manual to become aware of the proper care and maintenance of their new equipment to ensure a long usable life for the chair and delivery systems and to avoid the risk of injury to the operator or their patients.

Should you have any questions regarding the content of this manual or about any aspect of the installation, use, or maintenance of this new equipment please call Flight Dental Systems at the appropriate numbers listed on the contact page.

Overview

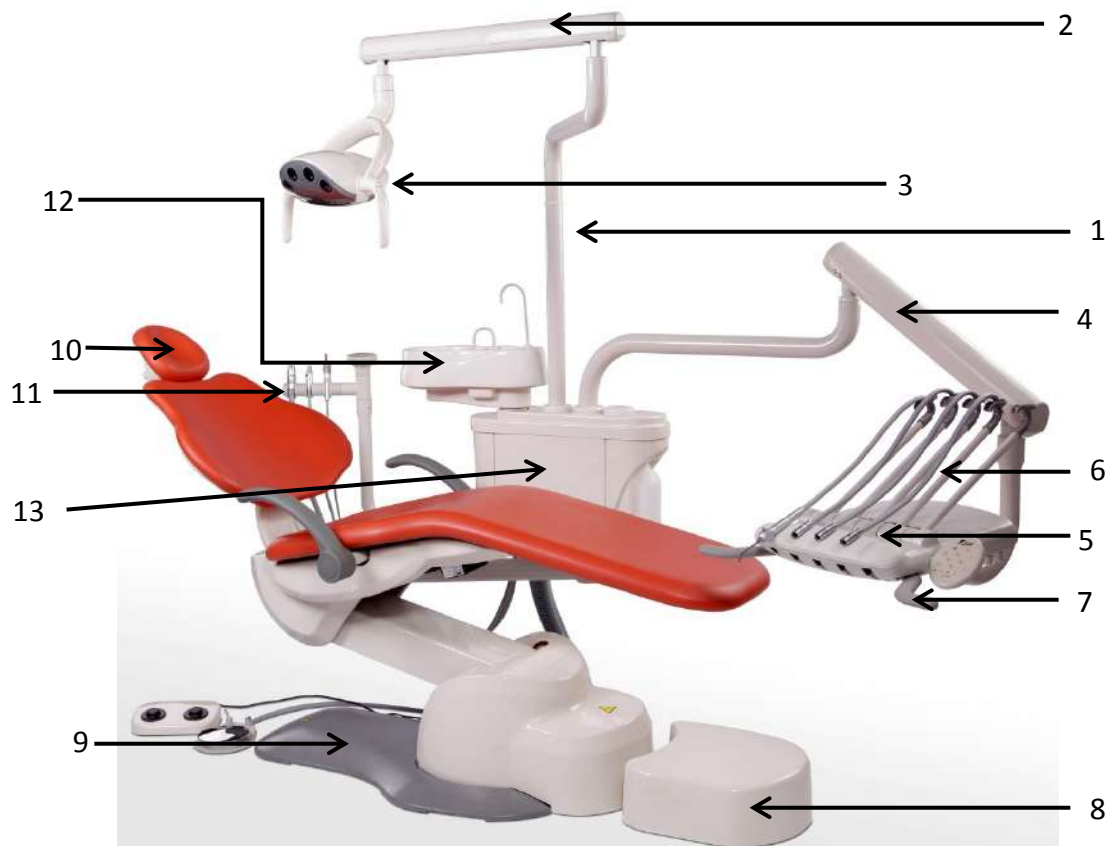

1. Vertical Light Post
2. Light Flex Arm
3. Light Head
4. Treatment Tray Flex Arm
5. Unit Head/Treatment Tray
6. Handpiece Tubing Holders
7. Air Brake
8. Junction Box Cover
9. Chair Base Plate
10. Double Articulating Headrest
11. Assistant Instrumentation
12. One Piece Ceramic Cuspidor
13. Side Utility Box

Overview of the Features

The Flight Dental chair is designed with the ease of operation and maximized efficiency for the practitioner and comfort of the patient in mind. Each A6-E chair is controlled by one electric motor (to control the backrest) and one hydraulic motor (to control the base) with both manual and programmable controls for movement. The chair is entirely constructed of cast aluminum to ensure durability and provide ease of asepsis. The movable armrest allows for easy entrance and exit. With the thin backrest, double articulating headrest, and the smooth, ergonomically correct chair movement, the A6-E chair provides a relaxing experience for the dentist and patient during treatment.

The Flight treatment light may be unit or ceiling mounted. Unit mounted lights can be controlled by the doctor or assistant from the integrated touchpads or from the switches located on the light itself.

General Information

Minimum Requirements

- Electrical wires must be standard and grounded.
- The preset stationary position of the dental chairs is locked once installed. Do not adjust and allow for professional adjustment.

Ideal Working Conditions

The following is the ideal conditions that will optimize the performance of your dental unit.

- 1) Environment temperature: 5° to 40°C (41° to 104° F)
- 2) Relative humidity: 20% - 80%
- 3) Atmospheric pressure: 86 to 106 kPa
- 4) Electrical source AC: 110/220V, 50-60 Hz± 1Hz, power 1800VA (maximum)
- 5) Electromagnetic compatibility: This product has been evaluated to Electromagnetic Compatibility as per IEC 60601-1-2. It conforms to all the necessary standards and therefore deemed safe for operation with other devices.
- 6) Mode of operation: Continuous operation except dental chair. Chair duty cycle 6%.
- 7) Electrical power transformed to maximum 24V by transformer. All wiring within chair and unit is low voltage of either 12V or 24V.
- 8) Shipping weight including shipping crate and packing is 285kg (627 lbs). Actual weight of chair, unit, cuspidor and light is 205 kg (453 lbs).
- 9) Please observe the patient chair maximum load capacity of 135kg according to EN ISO 6875.

Transport and Storage Conditions

Environment temperature: -10° to 60°C (41° to 104° F)

Relative humidity: 10% - 90%

Atmospheric pressure: 60 to 106 kPa

Specifications and Conformance to Standards:

HR Dental Products Inc. has implemented and maintains a Quality System certified to ISO 13485:2003

This equipment is approved by Health Canada, FDA, CE Mark (Europe), TGA (Australia) SFDA (Saudi Arabia)

All water and air supplies to unit must meet national regulations for air and water quality for human use

Chair Foot Control has IPX1 degree of protection against liquids

Statement of Intended Use:

The Flight Dental Systems A6-E Patient Chair is intended to supply power and serve as a base for dental devices and accessories. The product includes a dental operative unit. The device may also include a cuspidor and a central vacuum valve system. The use intended is in the treatment of patients in the dental clinic/office environment and by trained dentists, dental hygienists, dental

technicians and dental assistants use the device. The device may be attached to a dental chair using an industry standard 2" mounting post.

Compatible Accessories

Flight Dental Systems equipment is compatible with most standard accessories as follows:

- Standard handpiece tubes fit four hole Midwest Style handpieces and accessories.
- Fibre-optic tubing is ISO-C (six pin tubing).
- Cup fill settings can be set to fill any standard size cup from 3 to 5 ounces.
- Handpieces hangers will accept any standard size air driven or electrical motor handpiece.
- Quick disconnect accepts any 1/4" quick disconnect male insert.
- 1 7/8" vacuum trap filters – 2 hole and industry standard air syringe tips
- High volume and saliva ejector valves accepts North American standard tips.

Warning

To avoid personal injury or material damage please observe the warnings and safety information provided in this manual, on the equipment and on the product packaging.

Installation

Tools Required for Installation

- Allen (Hex) Keys Sets (Metric and Imperial)
- Phillips screw driver – Medium Size
- Slot head Screw Driver – Medium Size
- Slot head Screw Driver – Extra Small size
- Fish Tape
- Needle nose pliers – Medium Size
- Moving dolly with pull rope
- 10" Magnetic level
- Standard pliers or cutters
- Hammer drill
- Utility knife
- Handpiece Pressure Gauge

Basic Installation

This is a systematic overview with diagrams to help you quickly install the dental unit for operation. A two man team can install any Flight system in as little as one hour; however, it is preferred to have a minimum of three technicians in attendance for installation because of the weight of the equipment.

The Flight model operatory system is shipped fully assembled with the exception of upholstery and treatment light, which must be installed in the operating room. In most cases the chair can be unpacked by loading it on a shipping dolly and wheeling it into the operating room for final placement and connection to the plumbing and electrical fixtures.

In certain cases, because of narrow doors or hallways, the cuspidor and delivery system must be removed from the chair to allow the chair to fit through the door; the cuspidor and delivery system can

then be transported by dolly to the operating room for reassembly. Please note the overall dimensions of the chair and the delivery system relative to the dimensions of the door and the hallway prior to the transportation of the package into the operating room.

Positioning of Chair in Operating Room

Proper operation of the dental unit requires that sufficient space be left around the chair to accommodate the operator and assistant as well as entry and exit for the patient.

We suggest the unit should be arranged in the following manner according to the figure below.

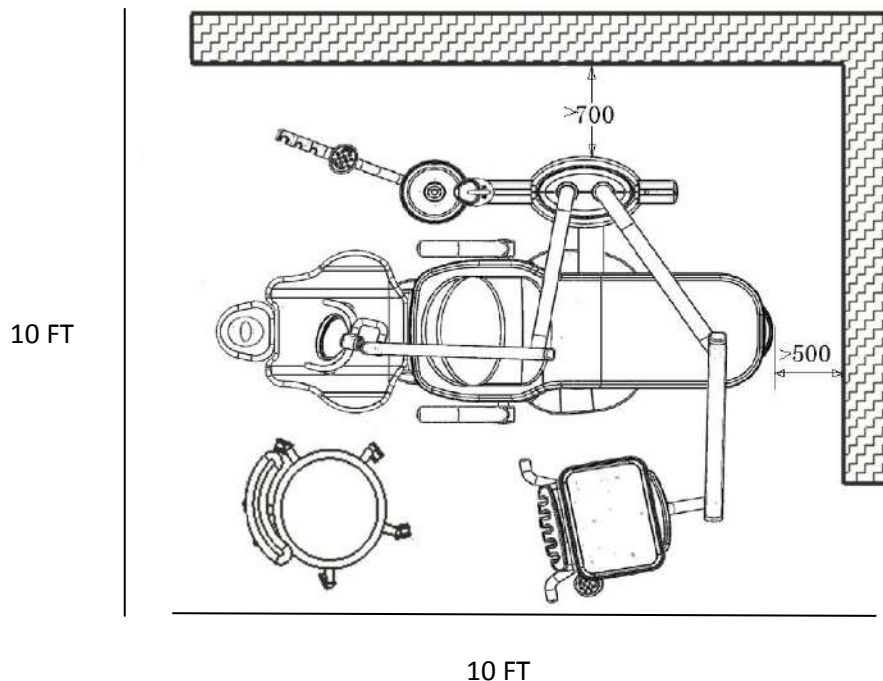

Provision of Utilities to the Dental Unit

The FLIGHT system normally requires the provision a 110/220V electrical supply. The necessary connectors will be found in a plastic bag stored within the floor box or inside the treatment tray. A backflow prevention device must be installed at the connection point of unit to office plumbing or elsewhere in the office in accordance with all federal, state, provincial, and local regulations.

Junction Box Utility Connections Specifications

ELECTRICAL:

- ½" conduit and box with quad or equal receptacle supplied by contractor.
- Wire box as per code with top of the box no higher than 4 ½" above finished floor.
- Voltage: 115 Volts AC 3 wire or 230 Volts AC 3 wire.

Note: Place trap in line and use vented fitting to conform to local codes. Supplied by contractor. Floor mounting only.

- Local regulations may require that licensed plumbers and electricians install utilities.
- Make sure all plumbing conforms to prevailing local codes.

Use the junction box template to determine floor locations for connections.

Securing Chair Base

Flight provides a metal bracket to secure the chair base to the floor. This will help to provide additional stability for the chair and to prevent chance that the chair may cause any injury. A bracket is provided in your parts to secure the chair. Please see diagram of where to secure the chair to the floor.

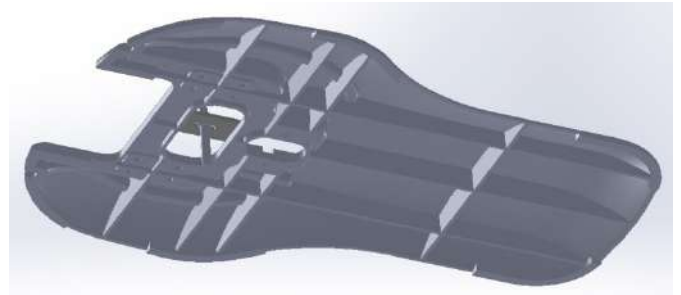
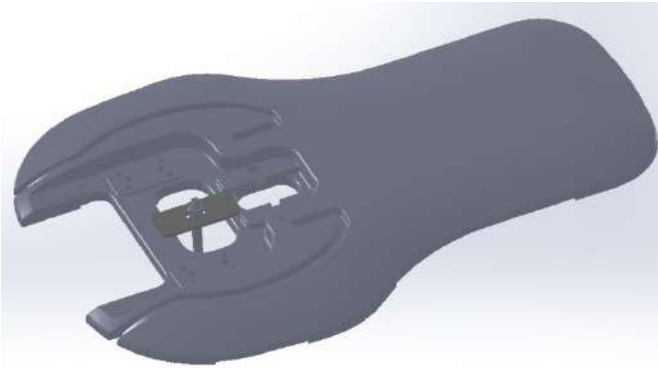

Please use the proper securing bolts according to your flooring material.

Operation of the Dental Chair

Power On/Off Button

The power on/off for the chair is a green switch located on right side of the chair base. The switch is illuminated when the chair is plugged in and the power is on. This allows the entire system to become functional at the touch of a button. When the power on/off button is pressed in, a buzzer will ring two times, while pushing the valid key, the buzzer rings one time. When the button is out, the system will not be functional.

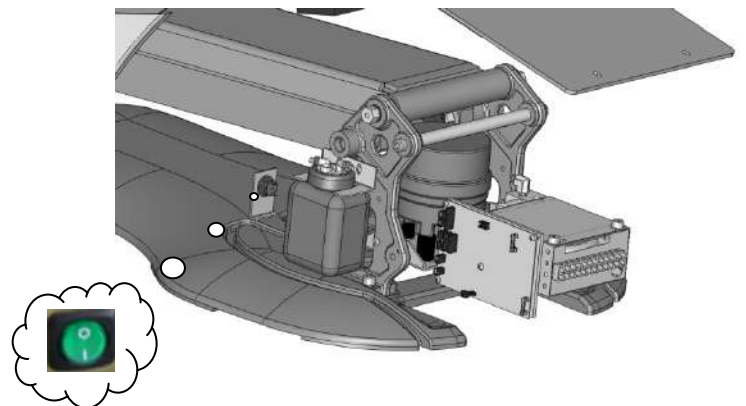
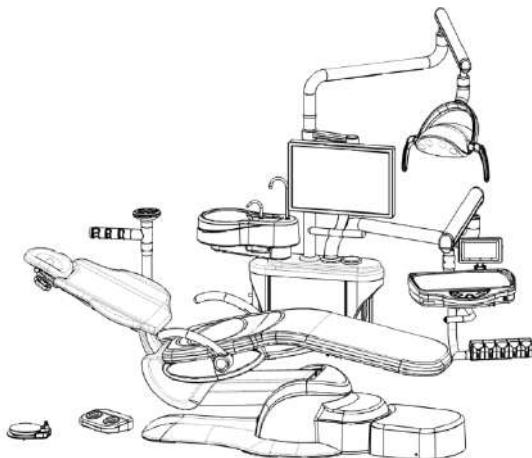

Control Panels for Movement of the Flight Unit

Each Flight chair can be operated either manually or with programmed controls on the touchpads or on the deluxe foot control. Using the foot control or the arrows on the touchpad, the chair position can be manually controlled. Programmable functions can be stored in the designated memory buttons.



Deluxe Foot Control

Touchpad Functions – On TRAD -2001 Treatment Tray

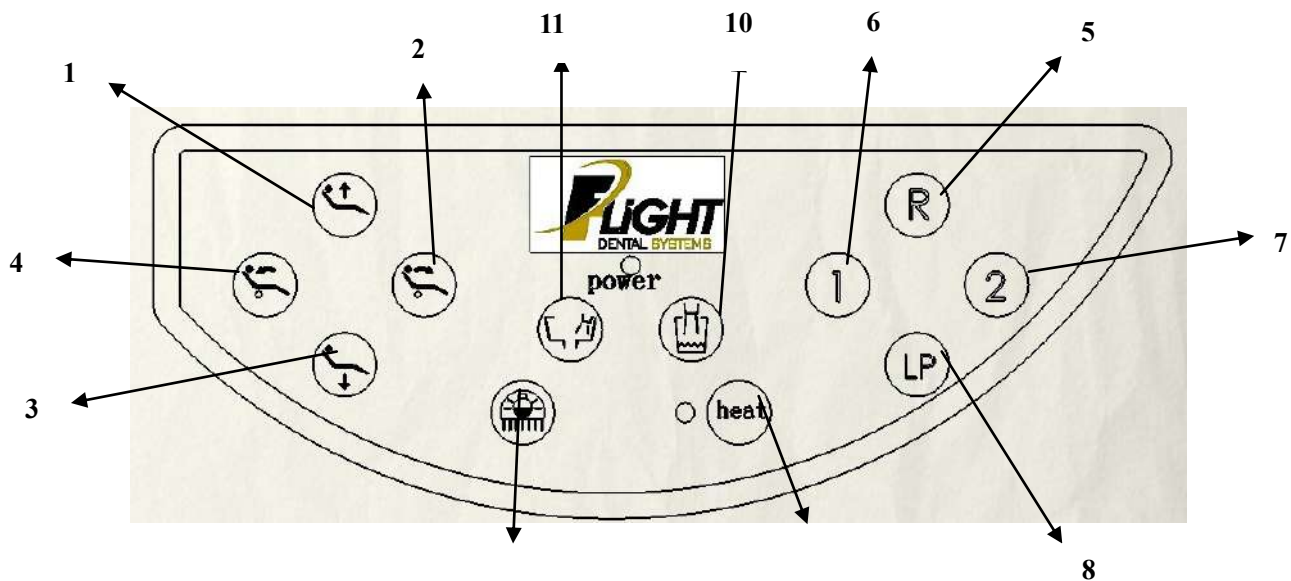

- | | |
|-------------------------------------|--|
| 1. Chair Base Up | 7. Memory Position Number Two |
| 2. Backrest Forward | 8. Return to Last Position |
| 3. Chair Base Down | 9. Syringe Heater On/Off * |
| 4. Backrest Down | 10. Activate Cup Fill |
| 5. Reset Chair to Original Position | 11. Activate Bowl Rinse |
| 6. Memory Position Number One | 12. On/Off/Intensity - Treatment Light |

*Syringe Heater Function is not available on chairs sold in Canada, United States or European Union.

Touchpad Functions – On TRAD -2002 Treatment Tray

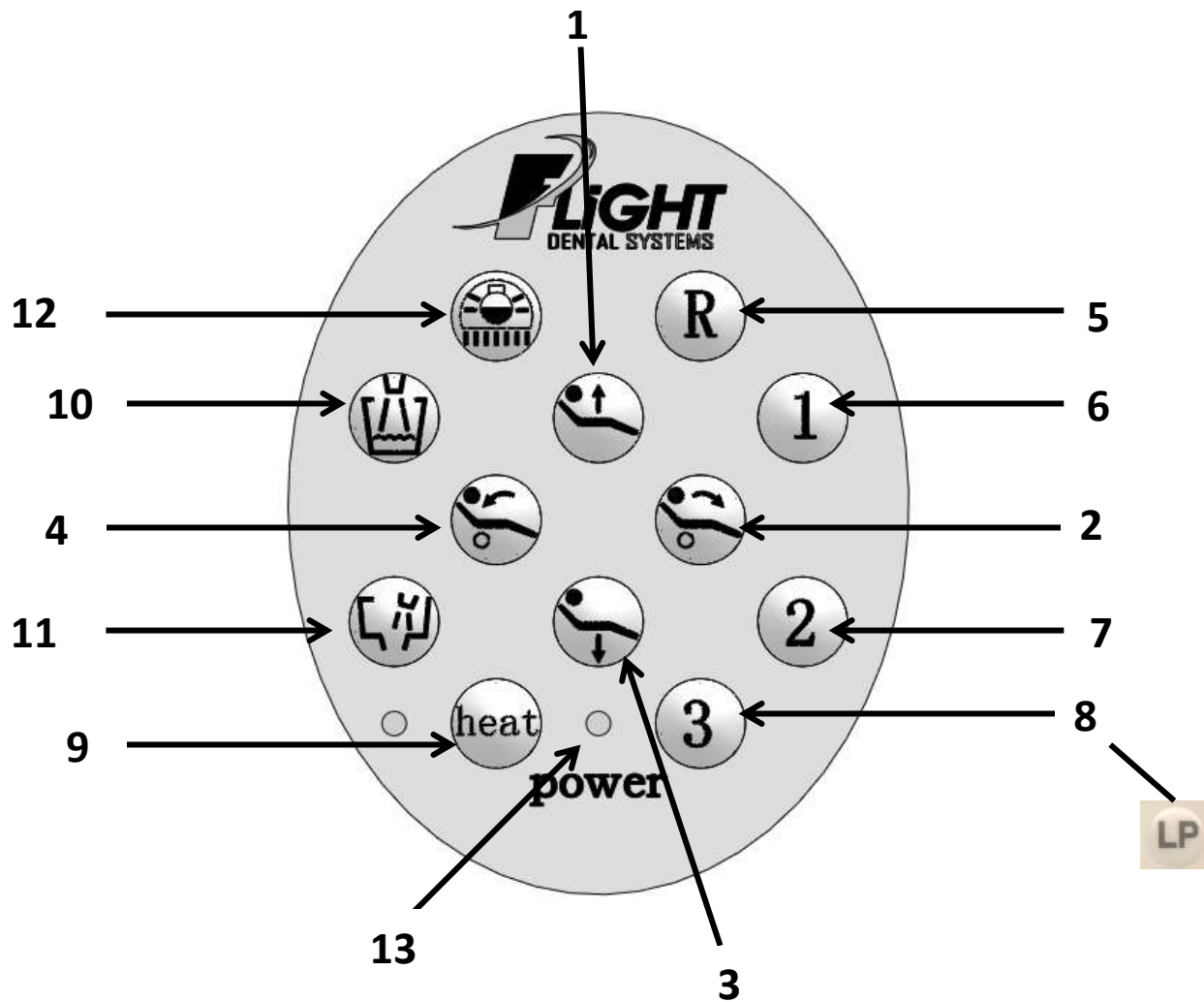

1. Chair Base Up
2. Backrest Forward
3. Chair Base Down
4. Backrest Down
5. Reset Chair to Original Position
6. Memory Position Number One
7. Memory Position Number Two
8. Return to Last Position
9. Syringe Heater On/Off *
10. Activate Cup Fill
11. Activate Bowl Rinse
12. On/Off/Intensity - Treatment Light
13. Power Indicator

*Syringe Heater Function is not available on chairs sold in Canada, United States or European Union.



Movement of chair

Manual Mode

The up and down keys allows for vertical movement of the chair. Press the up key to raise the chair and hold until desired height is reached or until the maximum height is reached. Press the down key to lower the chair and hold until the desired height or the maximum depression is reached.

The forward and backward keys allow for tilt movement of the chair. Press the forward key to tilt the chair forwards and hold until the desired position or the maximum forward tilt position is reached. Press the backward key to tilt the chair backwards and hold until the desired position or the maximum backward tilt position is reached.

Automatic Mode

This refers to programmable positions based on the practitioner's desire and can be constantly changed according to preference and needs. There are two adjustable memory position keys ( and ). Pressing each key will activate the chair to move to the programmed position.

Pressing the reset key  will reset the chair to the original patient entry position. This position is preset at the factory.

Pressing the last position key  position key will bring the chair backrest to the preset cuspidor position allowing the patient to easily access the cuspidor and rinse cup. The chair may then be returned to the working position using the programmed position buttons.

The chair movement may be stopped at any time during automatic movement by pressing the directional keys on the touchpad.

Programming the Chair

The dental chairs have programmable positions that accommodate the doctor's preferences. To Program your chair please follow these steps:



1. Adjust the chair to the desired position using the manual keys.
2. Once in place, press one of the memory position keys and hold for 5 seconds.
3. Wait for the buzzer to ring twice. Your position is now set.

To set the second memory position, move the chair to the second desired position and repeat step 2 using the other memory position button.

Setting the Chair Soft Limits

The maximum high and low setting for the chair may be field set according to the individual requirements of the office. It is recommended that these settings be set by the technician at the time of installation at not less than 1" from the mechanical high and low limits of the chair.

Resetting the Chair Soft Limits

Press the Reset  and Chair Base Down key  simultaneously for 20 seconds until the buzzer rings continuously at a rapid frequency. Release the two buttons as soon as the buzzer starts to beep continuously.

First set the "double high" position by moving the chair base to the highest positions and then down slightly so that it is away from the mechanical limit switch. Move the chair back all the way up and then down slightly so it is away from the mechanical limit switch.

Press the LP key  once and the "double high" soft limits will be memorized and the frequency of the buzzer will decrease.

Set the "double low" position by moving the chair base all the way down and then slightly up so it is away from the mechanical limit switch. Move the backrest all the way down and then slightly up so that it is away from the mechanical limit switch.

Press the LP key  one more time, the ring of the buzzer will stop and the setting is finished.

Note: If the ring of the buzzer does not stop and continues ring at a rapid frequency in step 5, this means there is an error in the setting. Steps 2 to 5 will need to be repeated.

Upon completion of this procedure the chair base and backrests will not be able to move higher or lower than these preset limits. *It is important that the higher position is adjusted before the lower position. The process cannot be reversed and must be programmed continuously; otherwise, other operations cannot be carried thereafter.*

The Headrest

The FLIGHT chair includes a double articulating headrest. This headrest allows the placement of the headrest to virtually any position to ensure operator and patient comfort.

To set the position of the headrest, turn the knob at the back of the headrest in a counterclockwise direction to loosen the headrest movement. Position the headrest in the desired position and tighten the knob by turning in a clockwise direction to fix the headrest in the desired position.



The height of the headrest is adjusted by pulling and/or pushing the headrest from the slot in the backrest. When the glide bar reaches its maximum recommended working height (lower or upper), a marker will become visible on the headrest support. Do not use the headrest if the warning is visible.

Wheelchair Patients

The headrest can also accommodate patients in wheelchairs.

To adjust for wheelchair patients:

Slide the glide bar of the headrest upwards until it is away from the dental chair.
Rotate the glide bar 180 ° and slide it back into the backrest pushing it completely down.
Position the dental chair into its fullback up position.

The patient should be positioned so the wheelchair is back to back with the dental chair. You may need to position the chair height to accommodate the patient's height.

Patient Chair Up/Down Speed Adjustment

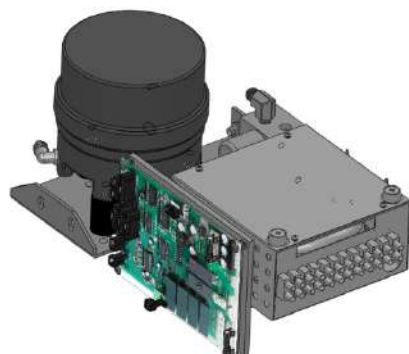
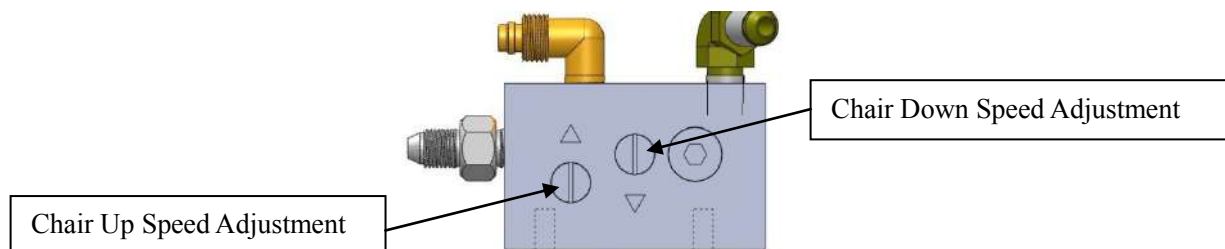

****Turn Clock wise for reducing speed and counter clockwise to increase speed**

Cleaning and Upholstery Care

Flight Dental Systems will not attempt to specify the required intervals or protocols for disinfection nor can it recommend the overall best surface disinfectant. Please refer to the Infection Control Recommendations published by the American Dental Association and to the Centre for Disease Control for further information.

Caring for Chair and Stool Upholsteries

As with all cleaning products, first clean a small inconspicuous area to ensure the material will not discolour or fade. It is recommended that each stain be cleaned in a stepwise manner using the sequence below:

Ultra Soft Upholstery

Clean spots with mild soap and water or an ordinary household cleaner such as Fantastic or 409 cleaners. Wipe off any soap residue with a clean damp cloth.

Air dry or dry quickly with a warm setting of a hair dryer.

For stubborn stains use a mild solvent.

Dry cleanable by conventional methods using commercial dry cleaning solvent.

Other Tips

- Always apply cleaners with a soft white cloth. Avoid the use of paper towels.
- When using strong cleaning solutions such as alcohol, it is advisable to first test in an inconspicuous area.
- Never use harsh solvents or cleaners that are intended for industrial use.
- To restore luster, a light coat of spray furniture wax may be used.
- Apply to chair; allow to set for 30 seconds. Lightly buff dry with a clean, dry cloth.

Barrier Technique

Flight Dental Systems strongly advocates the barrier technique be used whenever possible to preserve the finish and appearance of the equipment. Wherever possible disposable barriers should be used and changed between patients. The barrier technique will ensure maximum long-term durability of the surfaces and finishes of the equipment. Barriers may be purchased from your local dental supply dealers that will cover the unit touch pads, light switch and handles, air-water syringes, air-brake handle and the chair including headrest. These barriers should be removed and replaced after every patient.

In barrier compromised or inapplicable touch and transfer surfaces, the area must be properly cleansed, chemically disinfected and sterilized.

Chemical Disinfection

Regardless of the chemical disinfectant used, it is imperative that the equipment be thoroughly washed with mild soap and warm water at least once per day. This wash down will minimize the harmful effects of chemical disinfection residues being allowed to accumulate on the equipment.

When using chemical disinfectants, always pay strict attention to the manufacturer's disinfectant directions.

When using concentrated disinfectants, measure the concentrate carefully and mix according to package directions. Disinfectant solutions that are relatively harmless to surfaces at their recommended strengths can be corrosive at higher than recommended dilution ratios.

Unacceptable Disinfectants

These disinfectants will harm the surface finishes of dental equipment and are not recommended.

Use of these products will void your warranty.

Strong Phenols / Phenol-Alcohol combinations – examples - Lysol, Lysol 2, Lysol Professional, Coe Foam, Coe Spray, Vitaphene, Omni II
Sodium Hypochlorite / Household Bleach – examples – Clorox, Ajax, Purex
Strong Alcohol based solutions – exceeding 19% alcohol by content
Household Cleaners

Conditionally Acceptable Disinfectants*

The following disinfectants have been found to be the **least harmful** to the equipment surfaces by our test methods. Harmful effects of chemical disinfectant residues being allowed to accumulate on the equipment

Iodophors** - examples – Biocide, Aseptic-IDC, Wescodyne, Promedyne, Ido-Five
Glutaraldehyde – examples – Sterall Spray, Coldspore
Synergized Super Quat – Dis-cide, Kleenaseptic
Accelerated Hydrogen Peroxide – Chlorox, Scican Optim 33
Germiphene – E-Fect

*The Manufacturer makes no representation as to the disinfectant efficacy of these products. We make no warranty expressed or implied that these disinfectants will not damage the surface finishes. Damage and discoloration of the surface finishes are not covered under the warranty.

**Iodophor-based disinfectants will cause yellow staining on many surfaces. Regular washing with soap and water will minimize this staining. Iodophor neutralizers such as Promedyne are also available.

Contact Information

Thank you for taking the time to review the Flight Dental Unit's Owner Guide. Your feedback or comments regarding the document is welcomed. For any comments and concerns please mail, e-mail or phone us at:

Sales and Marketing

sales@flightdentalsystems.com

1-866-799-0517

905-799-0517

Technical Support

1-866-799-0517

905-799-0517

Parts and Warranty

1-866-799-0517

905-799-0517

Mailing and Shipping Address (Office)

21 Kenview Dr, Unit 11

Brampton, ON Canada L6T 5G7

L6T 5G7

Chair Structure Spécifications (mm-inch)

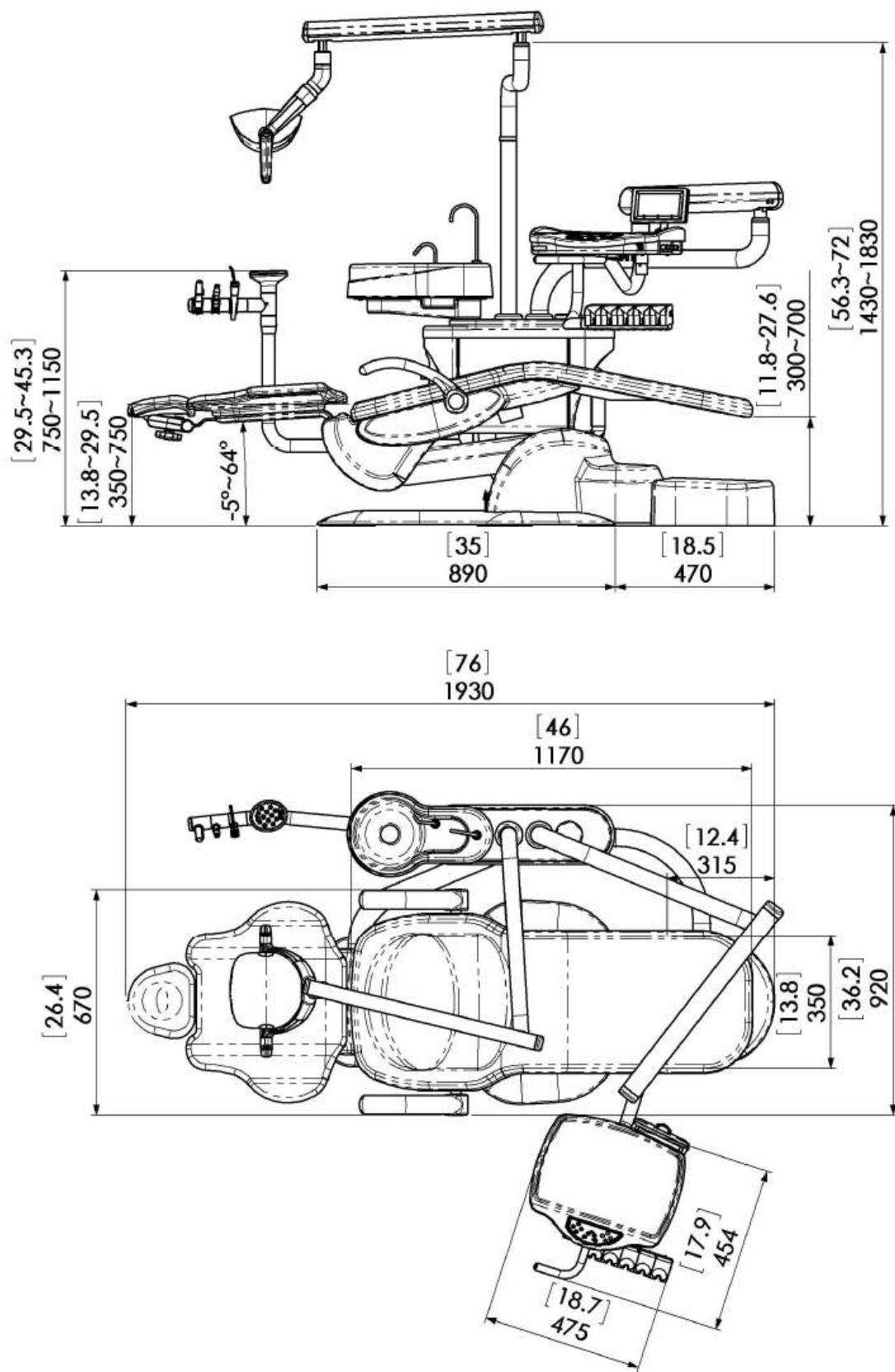

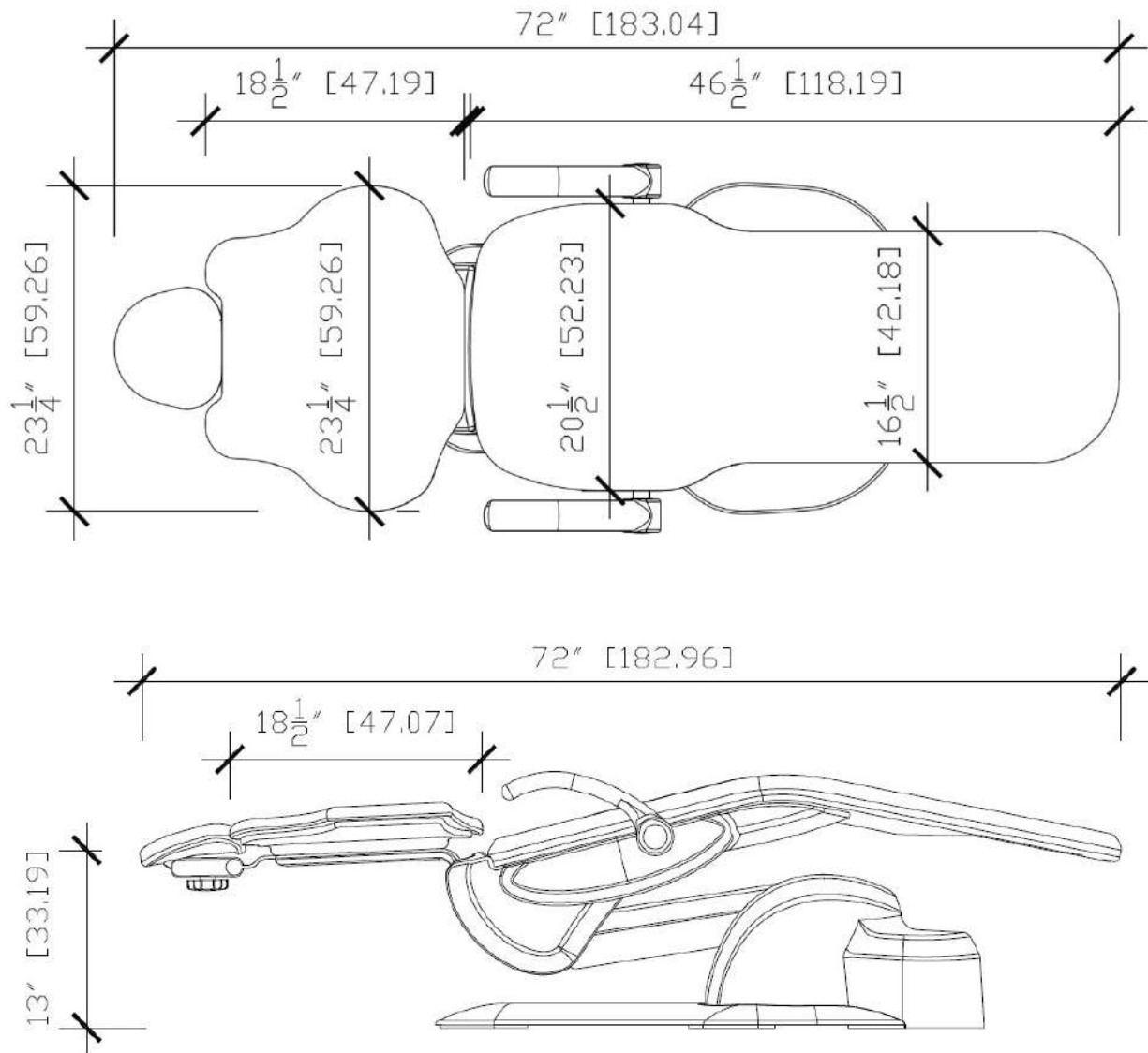

Electrical/Hydraulic Diagram

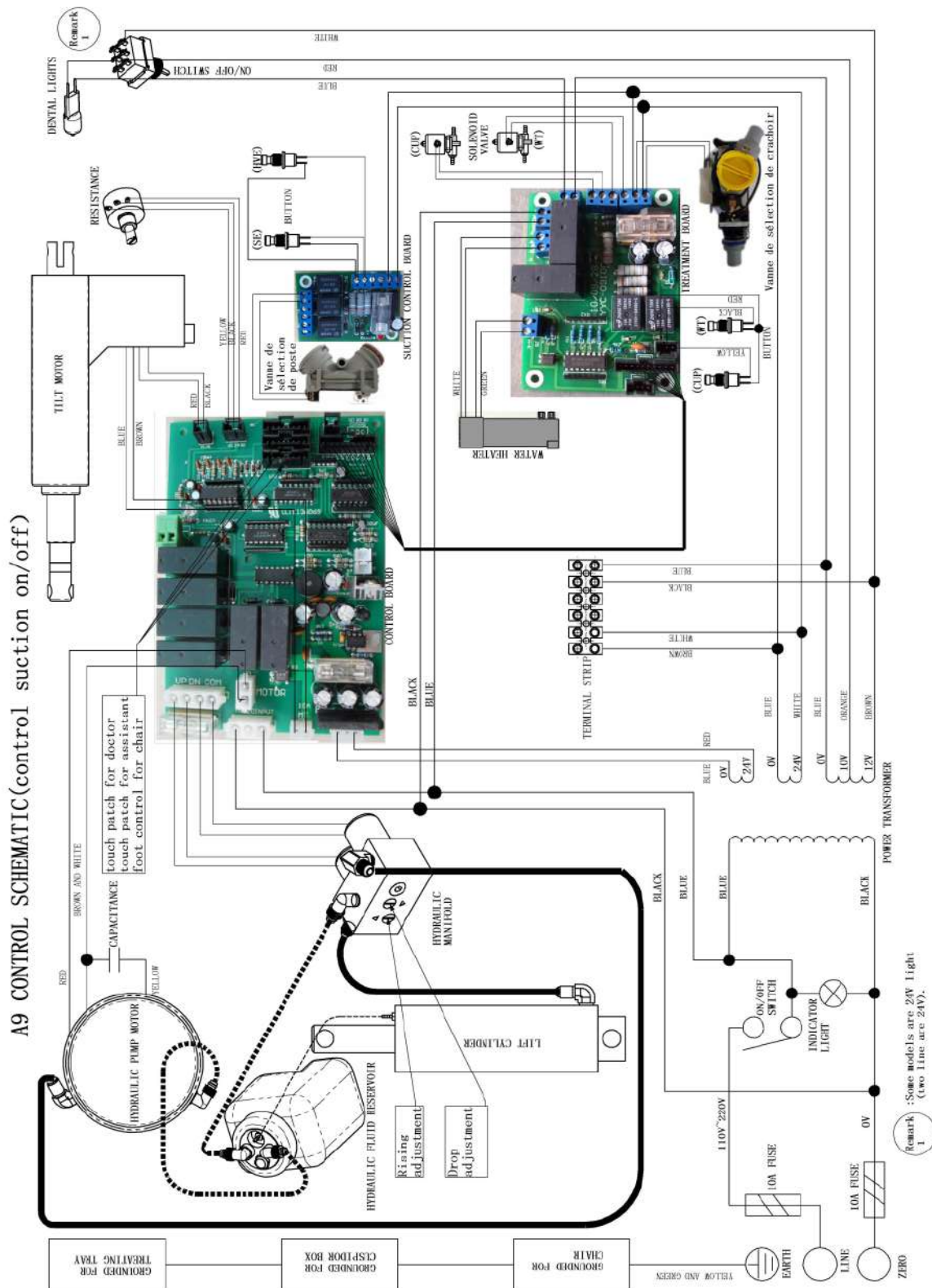

Main Circuit Board Diagram

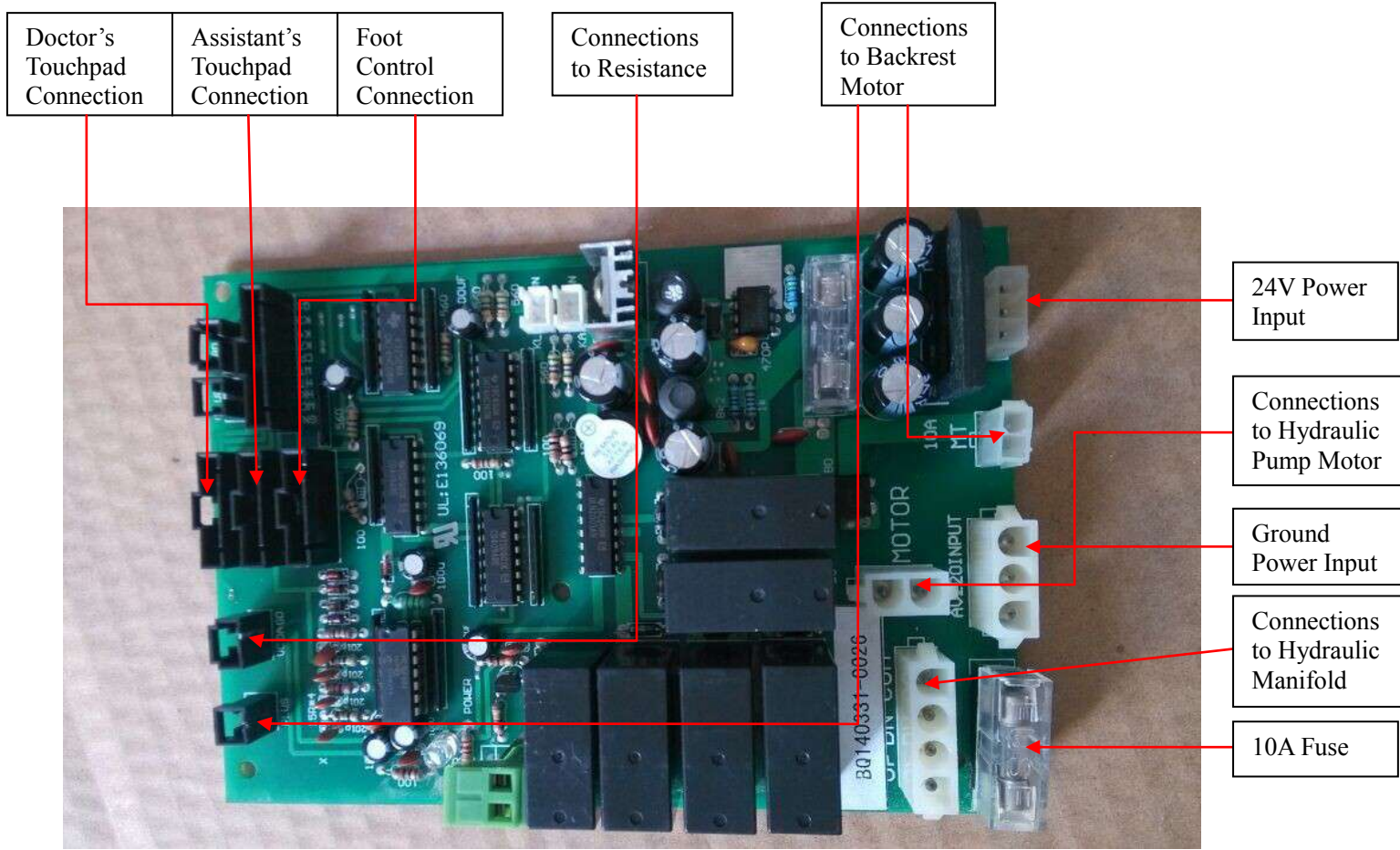

Electrical Connection from Transformer for A6-E Chair

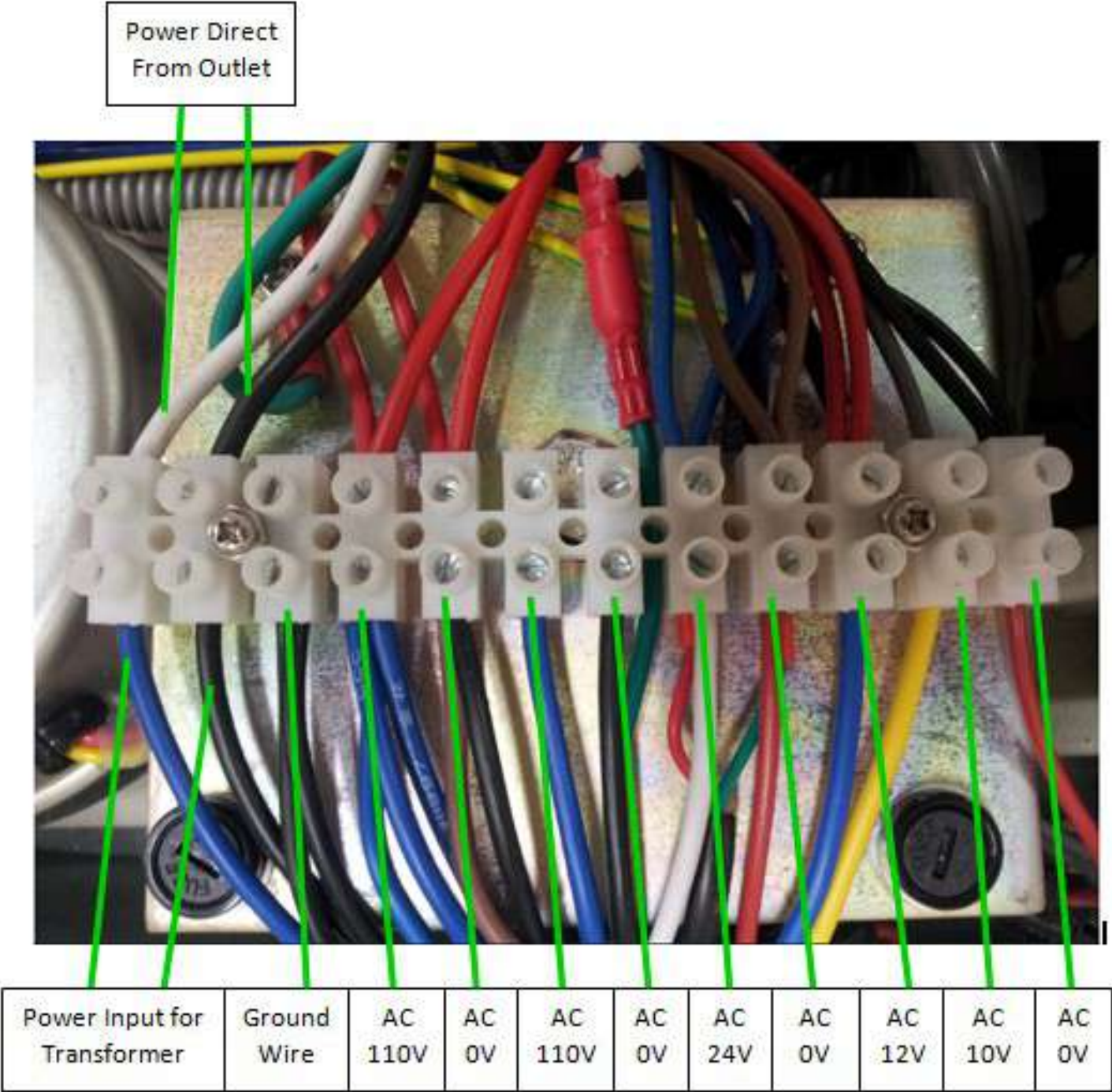

Warnings and Notes

1. This product has not been evaluated to Electromagnetic Compatibility as per IEC 60601-1-2. Hence this equipment shall be operated suitably away from other electrical and electronic equipments to avoid any mutual Electromagnetic interference”.
2. Caution: Federal Law restricts this device to sale by or on the order of a dentist
3. Pressure gauge supplied within doctor’s handpiece element is provided as a rough guide only to the unit air pressures. Technicians must use a properly calibrated Handpiece Pressure Gauge to confirm and adjust the exact pressures delivered by the individual handpiece tubing’s. See DCI Handpiece Pressure Gauge Model 7263.
4. Detailed circuit diagrams, component parts lists, descriptions, calibration instructions and other information that will assist appropriately qualified technical personnel to repair those parts of the equipment which are designated by the manufacturer as repairable are available upon request.
5. This equipment may be installed and serviced only by technicians who have been trained by HR Dental Products Inc. Damage to the equipment or other equipment or injury to service technicians, operators or patients that result from faulty installation and servicing methods are not the responsibility of HR Dental Products Inc. Components influencing the safety or operators, patients and third parties must always be replaced with original spare parts upon failure.
6. The chair and unit should be turned off prior to commencing any servicing or maintenance of the unit including cleaning. The unit may be turned off by placing the master on/off switch on the delivery head to the off position. The chair may be turned off by placing the internally lit green button on the chair base cover in the off position. (The light will turn off when the chair is off).

All users of the equipment should receive user training from a qualified service technician and must read this manual prior to using the equipment. Failure to follow the directions included in this manual may result in damage to the equipment and/or injury to the user or their patients.

Only handpieces equipped with anti-retraction devices may be used with this dental unit

Caution. It is important to ensure that the patient’s entire body including hands and legs are kept on the patient chair. The hands, arms and legs must not be allowed to hang over the edges of the patient sitting surfaces.

When the chair is moving via program or manual operation make sure that the patient does not under any circumstances come into contact with the flex arm, dentist’s element or utility center.

Make sure that stools and assistant element do not extend under the chair while the chair is moving. Failure to heed this caution may result in damage to the chair, stools and or assistant element.

Never operate the operating (treatment) light with the cover removed. Pay attention to the temperature of the light surfaces before attempting to service the light or to change a bulb.

To guarantee the operational safety of electro medical devices the operation of mobile radio telephones in the hospital or practice area is prohibited.

When opening the equipment please observe safety measures for handling PC boards. Touch a ground point to remove any electrostatic charge before touching the components.

It is essential to the safe and effective operation of this dental equipment that regular inspections and servicing be performed by a trained technician. It is recommended that your technician perform a visual inspection and operating test of the equipment and the key components at least once every two years.

Marking and Warning Symbols



Classified with respect to electric shock, fire and mechanical hazards only accordance with CAN/CSA C22.2, No. 601.1.



Protective earth (ground)



Type B applied part

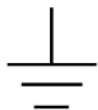

Functional earth (ground)



Attention, Consult ACCOMPANYING DOCUMENTS

Environmental

Environmental Specifications

Storage/Transportation Temperature: -40 C to 70 C -40 F to 158 F

Relative Humidity: 95% maximum

Operating Temperature: 10 C to 40 C 50 F to 104 F Relative Humidity: 95% maximum

Electromagnetic Compatibility:

This product has not been evaluated to Electromagnetic Compatibility as per IEC 60601-1-2. Hence this equipment shall be operated suitably away from other electrical and electronic equipments to avoid any mutual Electromagnetic interference”.

Flammable Gasses:

Not suitable for use in the presence of a flammable anesthetic mixture with air, oxygen, or nitrous oxide, where such gasses may accumulate in concentration (closed space).

Recycling and Returning Parts:

To prevent possible harm to the environment or human health from uncontrolled waste disposal, recycle it responsibly to promote the sustainable reuse of the material resources.

To return your used devices, please use the return and collection systems or contact the retailer where the product was purchased. They can take this product for environmental safe recycling.